



Compasso d'Oro ADI
Award 2014

DESIGN DAVIDE GROPPI - 2010
RECESSED CEILING LAMP - METAL



NULLA

The sizes are expressed in millimeters / inches.

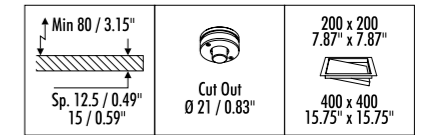
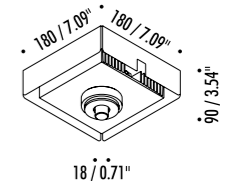

19160003	STANDARD - 3000K	MAX 1050 mA DC - 12 W LED - 530 lm - CRI > 90 VISIBLE HOLE Ø 18 mm - COMPULSORY INSTALLATION KIT NOT INCLUDED INCLUDES LED DRIVER INPUT 100-240 V - 50/60 Hz DALI - PUSH - 1-10 V DIMMABLE
19160003-27	STANDARD - 2700K	

COMPULSORY INSTALLATION KITS

16530403	MATT BLACK	PLASTERBOARD FLANGE 12,5 mm PLASTERBOARD CUT-OUT Ø 21 mm - MINIMUM SPACE FOR MOUNTING 75 mm
17430403	MATT BLACK - IP65	PLASTERBOARD FLANGE 12,5/15 mm PLASTERBOARD CUT-OUT Ø 21 mm - MINIMUM SPACE FOR MOUNTING 75 mm

OPTIONAL INSTALLATION KITS

16420003	STANDARD 200 x 200 mm	PLASTERBOARD PANEL 12,5 mm - PLASTERBOARD CUT-OUT 200 x 200 mm / 400 x 400 mm
16690003	STANDARD 400 x 400 mm	

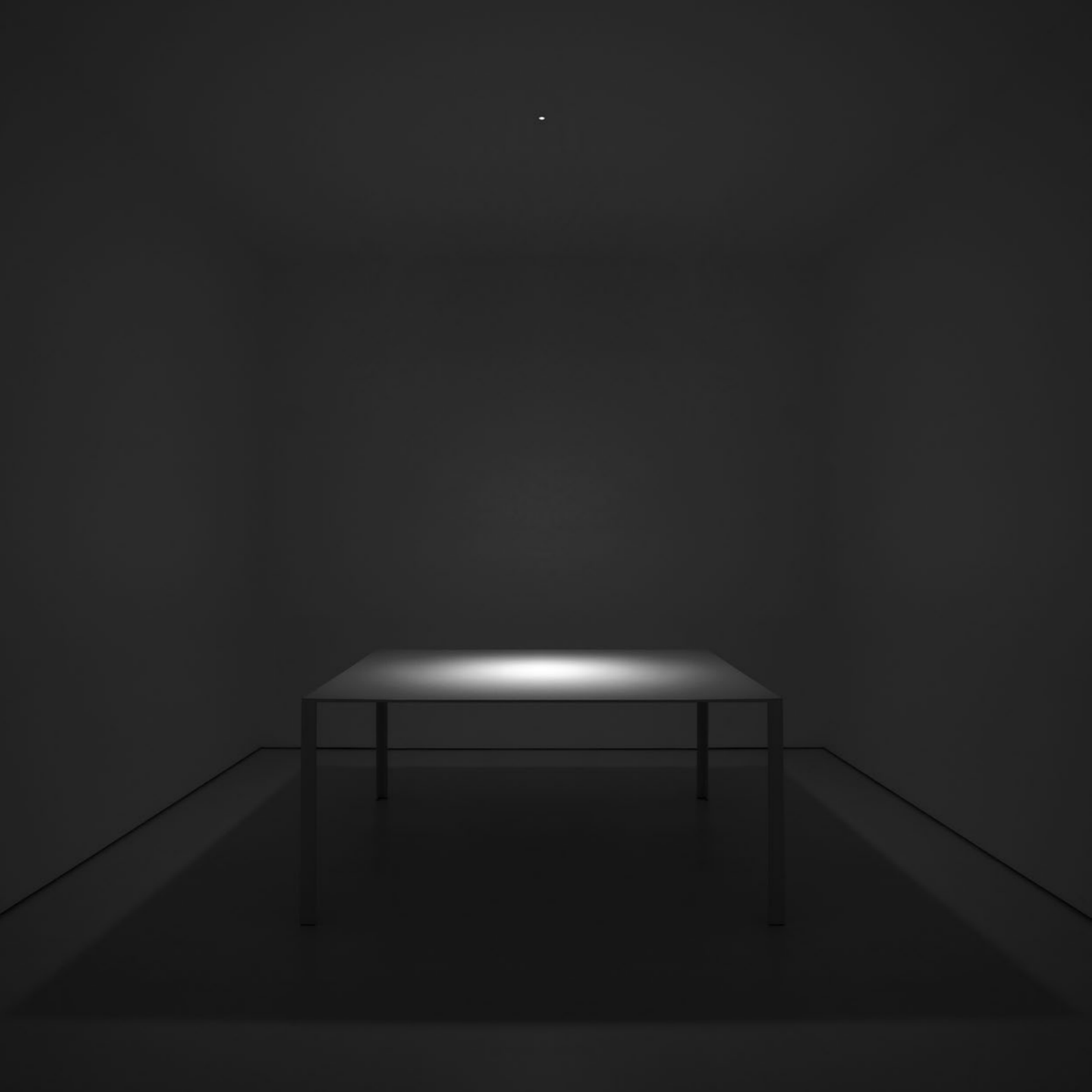



DRIVER DIMENSION

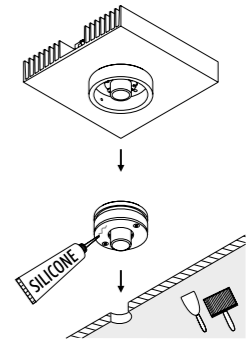
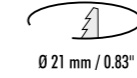
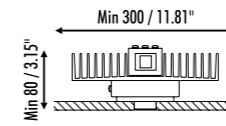
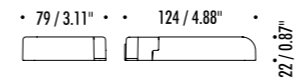

PLASTERBOARD ACCESS PANEL TO INSPECT THE LAMP
PUT THE DRIVER IN AN ACCESSIBLE PLACE
Min 150 / 5.90"
Max 15000 / 590.55"

